

# EPB-V With Preload

DN value	130000
----------	--------

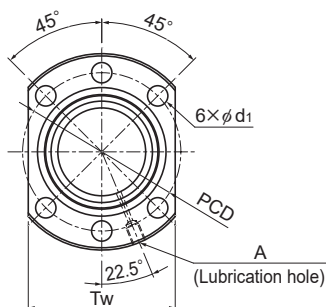

Model No.	Screw shaft outer diameter d	Lead Ph	Ball center-to-center diameter dp	Thread minor diameter dc	Loaded circuits Rows x turns	Basic load rating		Rigidity K N/μm
						Ca kN	C <sub>0a</sub> kN	
EPB 1605V-6	16	5	16.75	13.49	3×1	9.3	13.1	315
EPB 2004V-8	20	4	20.5	18.06	4×1	8.2	15.5	503
EPB 2005V-6	20	5	20.75	17.49	3×1	10.6	17.3	396
EPB 2006V-6	20	6	21	16.93	3×1	13.8	20.4	388
EPB 2008V-6	20	8	21	16.93	3×1	13.7	20.4	388
EPB 2010V-6	20	10	21.25	16.36	3×1	17.3	24.5	398
EPB 2504V-8	25	4	25.5	23.06	4×1	9.1	19.5	602
EPB 2505V-6	25	5	25.75	22.49	3×1	12.1	22.6	491
EPB 2506V-6	25	6	26	21.93	3×1	16.0	27.1	488
EPB 2508V-6	25	8	26	21.93	3×1	15.9	27.1	487
EPB 2510V-4	25	10	26	21.93	2×1	11.3	18.0	331
EPB 2512V-4	25	12	26.25	21.36	2×1	14.0	21.2	332
EPB 2806V-6	28	6	29	24.93	3×1	17.5	32.0	560
EPB 3204V-10	32	4	32.5	30.06	5×1	12.3	31.9	921
EPB 3205V-6	32	5	32.75	29.49	3×1	13.9	30.2	616
EPB 3205V-8	32	5	32.75	29.49	4×1	17.8	40.3	811
EPB 3206V-8	32	6	33	28.93	4×1	23.9	49.5	826
EPB 3208V-8	32	8	33.25	28.36	4×1	29.2	55.2	797
EPB 3210V-6	32	10	33.75	27.24	3×1	32.1	52.2	602
EPB 3604V-6	36	4	36.5	34.04	3×1	8.4	22.2	636
EPB 3606V-8	36	6	37	32.93	4×1	25.2	56.2	914
EPB 3608V-8	36	8	37.25	32.36	4×1	31.6	64.8	908

Note) When the QZ Lubricator and W wiper ring are attached, the overall length of the nut dimensions will increase. Contact THK for details.

### Model number coding

**EPB3205V-6 RR G0 +650L C3**

Model No.

Clearance symbol

Accuracy symbol

Ball screw shaft length (mm)

Seal symbol (RR : Labyrinth seal, WW : Wiper ring.)

